

Drzwi balkonowe 1 szt.

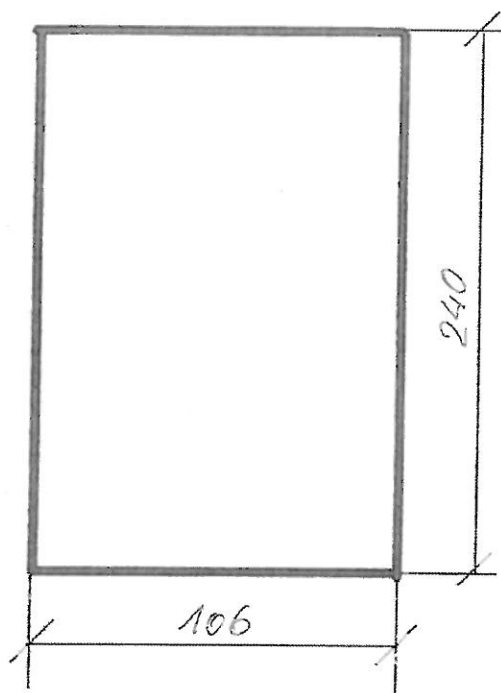

Okna 3 szt.

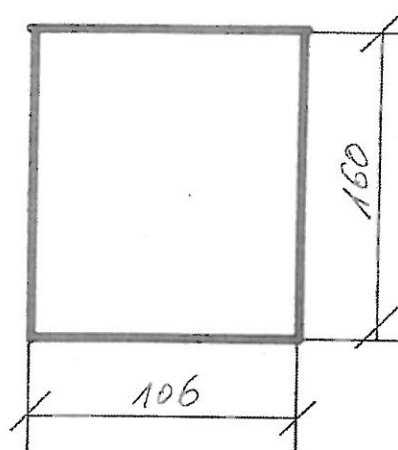

Okrzei 1/13

$$\begin{array}{r} S_{D_1} = 3,0 \text{ m}^2 \\ 2,54 \end{array}$$

$$S_{O_1} = 5,10 \text{ m}^2$$

$$\underline{\underline{\sum 7,64 \text{ m}^2}}$$

Okno 1 szt.

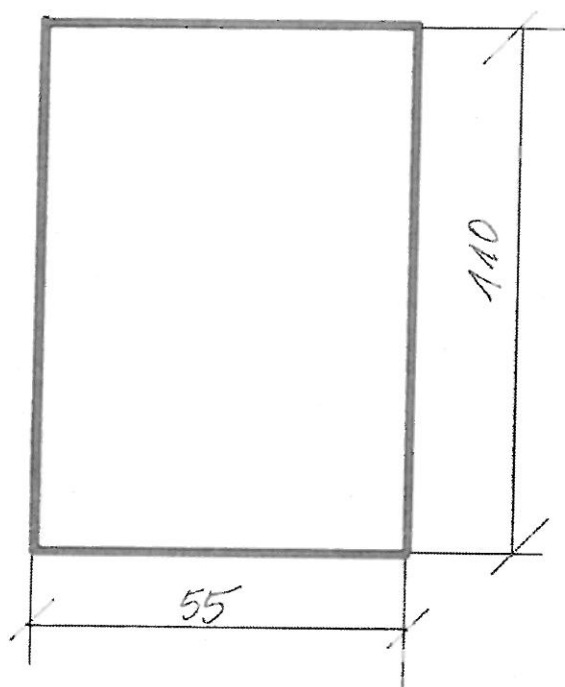

ul. Katowicka 37a/6

$$\sum S = 0,6 \text{ m}^2$$

Okmeri 4/7

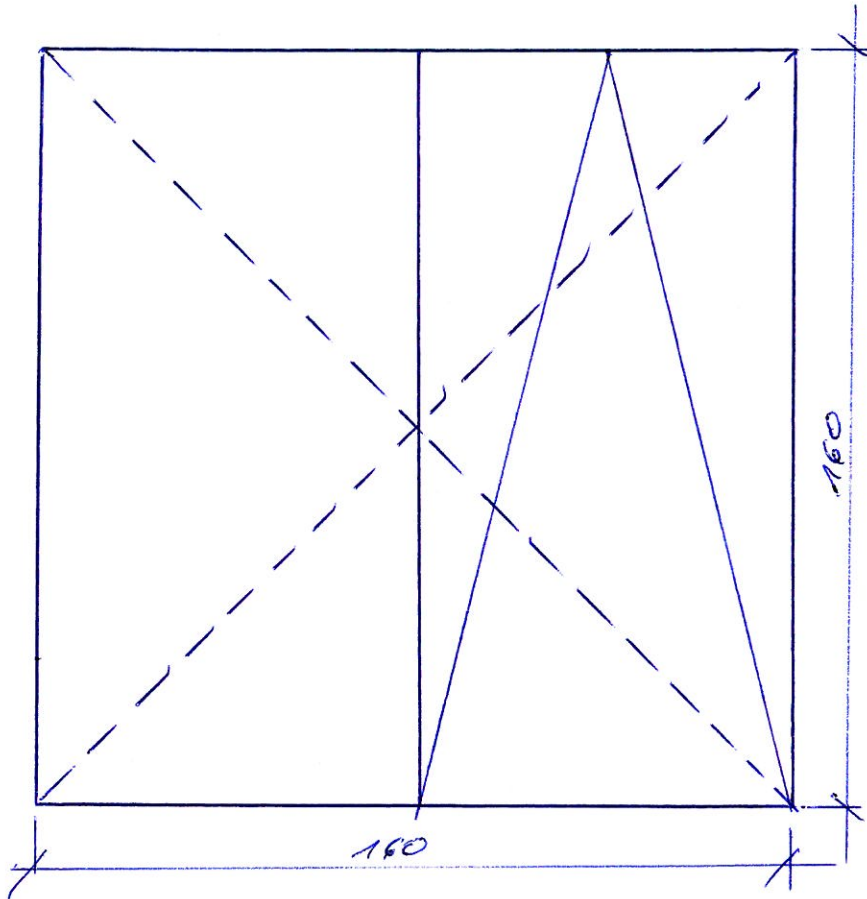

x 2 set.

Szkic stolarki okiennej Morawa 22/13

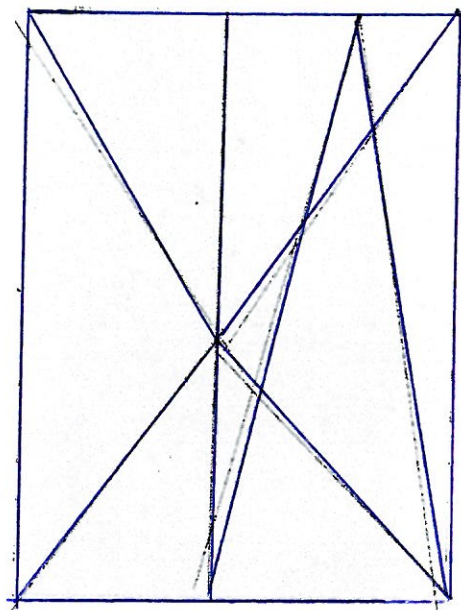

Wys 1,43

4szt

Szer 0,95

3

Szkic stolarki jednoramowej

ul. KOZIELSKA 10/6

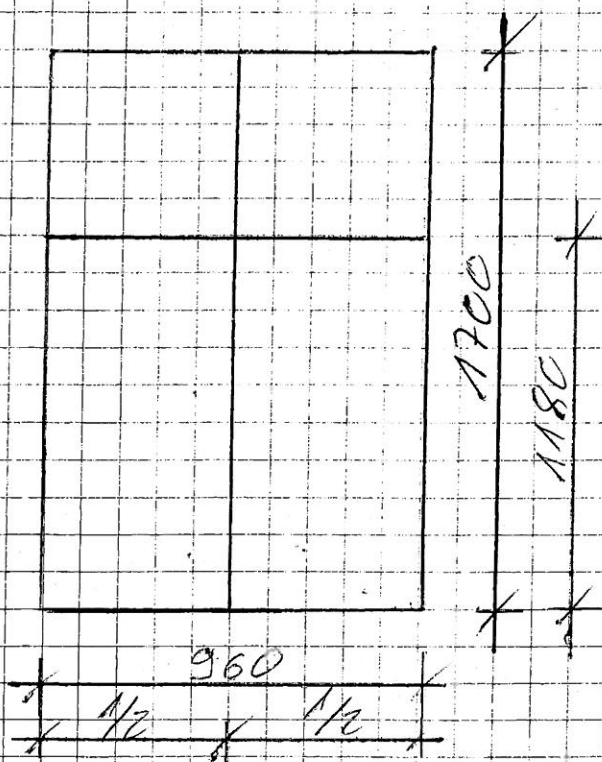

2 szt.

Zwirki i Wigrany 1/4

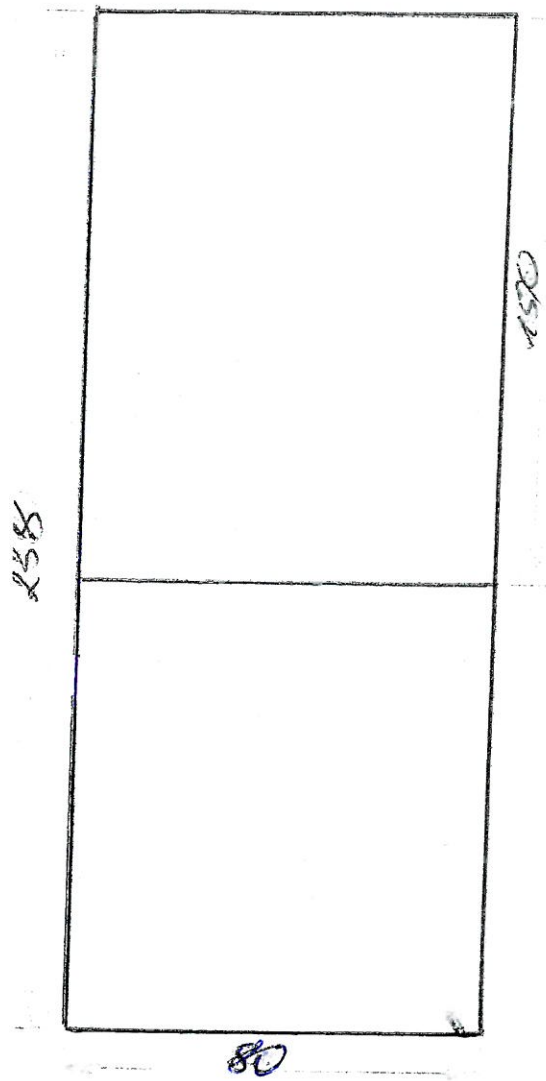

$\approx 7.7 \text{ m}^2$

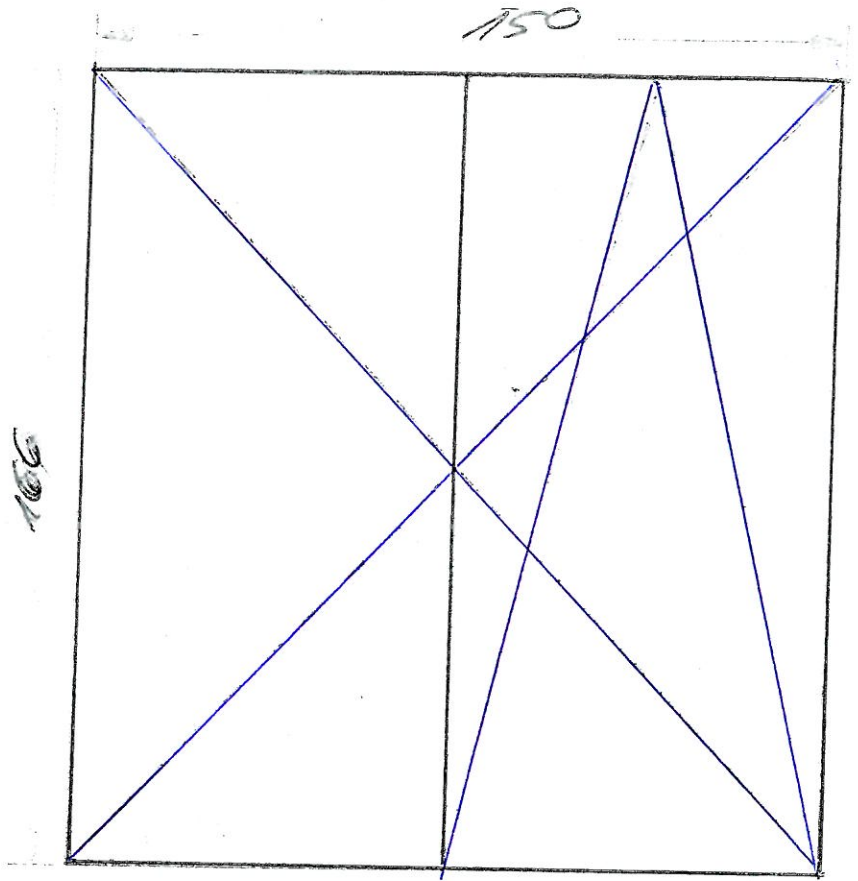

2x

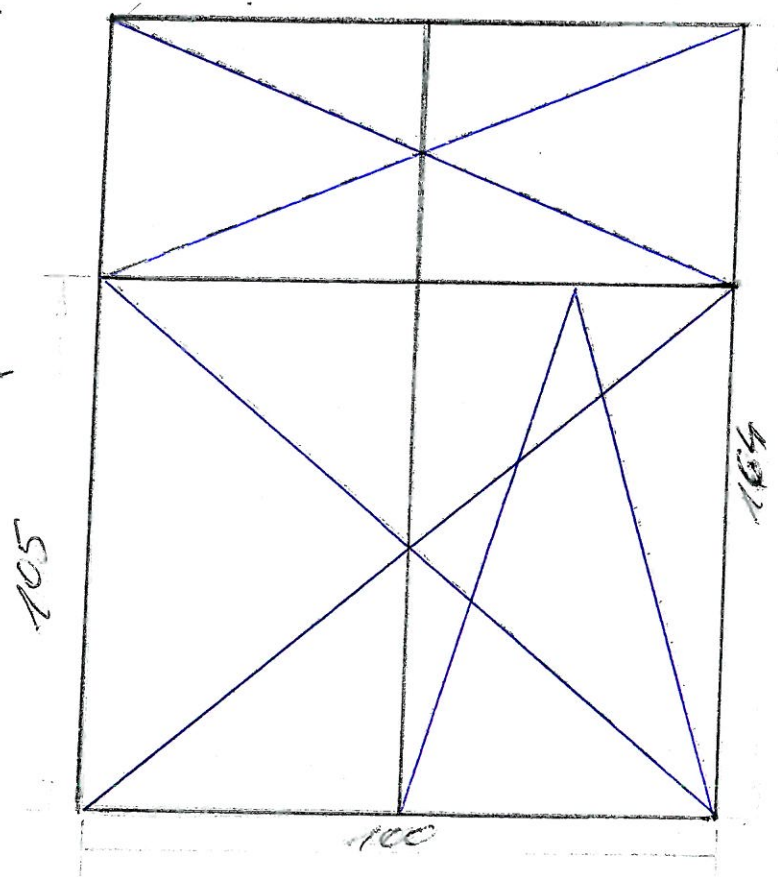

MIKOŁOWSKA 20B/1

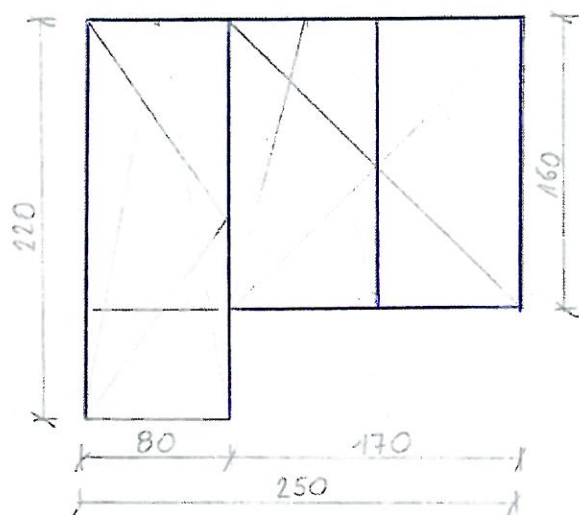

x 1 szt

POW. 4,49 m²

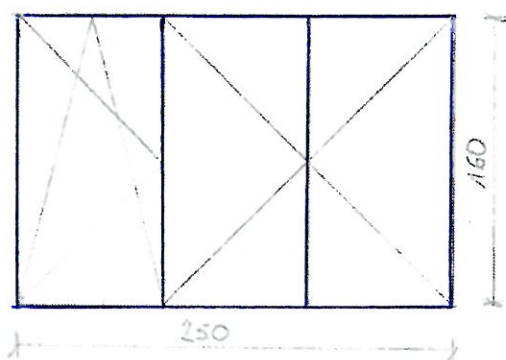

x 1 szt.

POW. 4,00 m²

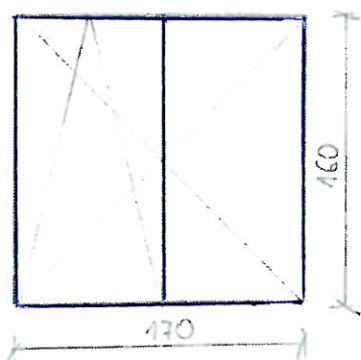

x 1 szt

POW. 2,72 m²

ŁĄCZNA POW. - 11,20 m²

ODDZIAŁ EKSPLOATACJI PRACOWNI 4
Zespół Kierownika
mgr inż. Józef Płota

Skłodowskiej 15/27

KUCHNIA

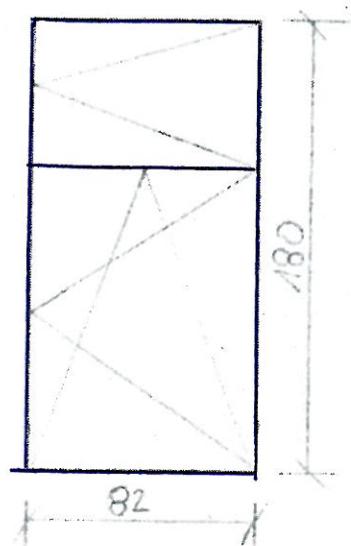

POKÓJ

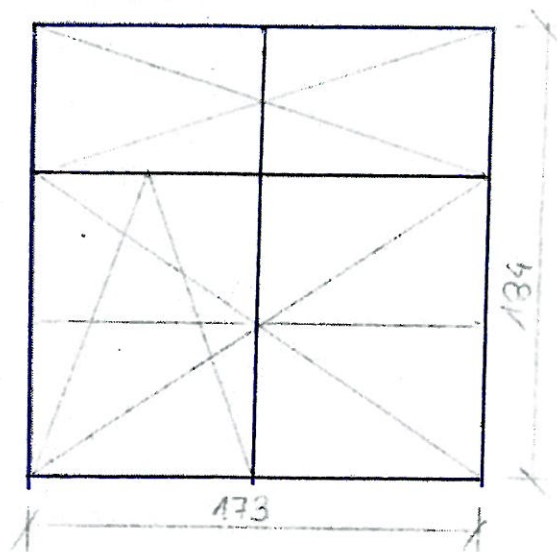

Do wymiany parapety wewnętrzne i zewnętrzne

Zeromskiego 8/9

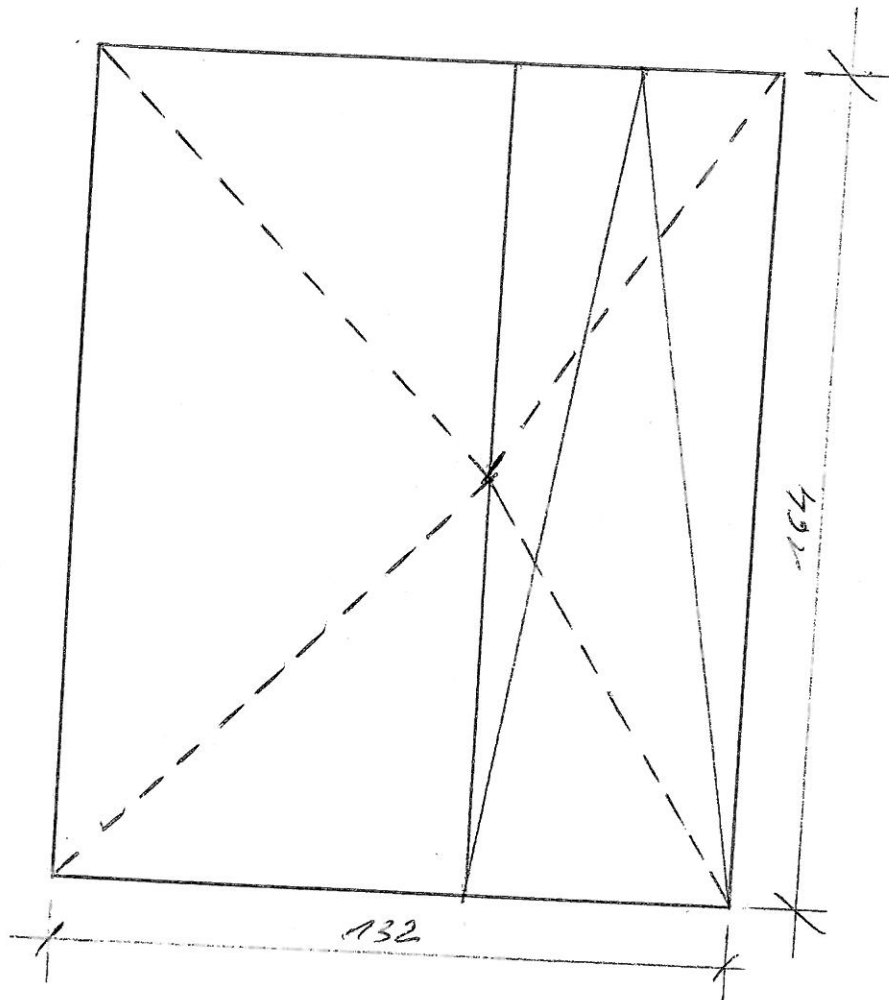

X 4 sat